

## PLANT SCHEDULE

SYMBOL	BOTANICAL NAME	COMMON NAME	HEIGHT	SPREAD	NO.	POT SIZE	STAKING
TREES							
ARB	Acer rubrum 'Bowhall'	Bowhall Maple	10m	5m	5	45ltr	3x38x38x1800mm
ER	Elaeagnus reticulatus	Blueberry Ash	6m	4m	2	75 ltr	3x38x38x1800mm
FA	Flindersia australis	Crow's Ash	15m	8m	1	75 ltr	3x38x38x1800mm
HP	Harpullia pendula	Tulipwood	7m	3m	2	25 ltr	3x38x38x1800mm
Street Tree	In accordance with Parramatta Council Street Tree Master plan				3	45 ltr	3x38x38x1800mm
SHRUBS & HEDGES							
Bm	Backhousia myrtifolia	Grey Myrtle	4m	as shown	3	150mm	Nil
Ca	Callistemon 'Anzac'	White Bottlebrush	1m	3m	6	200mm	Nil
Hi	Hebe 'Inspiration'	Lilac Hebe	1m	1m	38	200mm	Nil
Gf	Gardenia augusta 'Florida'	Gardenia	1m	1m	17	200mm	Nil
Gm	Grevillea 'Moonlight'	Moonlight Grevillea	4m	3m	2	200mm	Nil
Lt	Lomandra Tanika	Matt Rush	0.6m	0.6m	3	150mm	Nil
Nd	Nandina domestica	Sacred bamboo	2m	1m	9	200mm	Nil
Mc	Melaleuca linarifolia 'Claret Tops'	Purple Honey Myrtle	1.5m	1.0m	11	300mm	Nil
Ms	Magnolia soulajana	Pink Magnolia	4m	as shown	1	300mm	Nil
Pss	Pittosporum tenuifolium 'Silver Sheen'	Silver Sheen	4m	2m	14	300mm	Nil
Sar	Syzgium australe 'Resilience'	Lilly Pilly Resilience	2.5m	1m	26	300mm	Nil
SarAdv	Syzgium australe 'Resilience'	Lilly Pilly Resilience	2.5m	1m	16	400mm/45ltr	Nil
Sc	Syzgium 'Cascade'	Syzgium	2.5m	1.5m	43	200mm	Nil
ScAdv	Syzgium 'Cascade'	Syzgium	2.5m	1.5m	7	300mm/25ltr	Nil
GROUND COVERS							
Ah	Arctotis cultivars	Aurora Daisy	0.5m	0.5m	7	150mm	Nil
Ac	Arthropodium cirratum 'Matapouri Bay'	Rock Lilly	0.6m	0.6m	78	200mm	Nil
As	Agapanthus 'Snowstorm'	White Agapanthus	0.2m	0.4m	22	200mm	Nil
Cm	Clivea miniata	Clivea	0.5m	0.5m	10	200mm	Nil
Co	Convolvulus mauritanicus	Bindweed	0.25m	0.5m	46	140mm	Nil
Ga	Gazania Tiny Tom	Silver Gazania	0.3m	0.5m	122	150mm	Nil
Lm	Liriope muscari	Lilly Turf	0.4m	0.4m	128	125mm	Nil
Pm	Plectranthus Mona Lavender	Mona Lavender	0.5m	0.4m	16	150mm	Nil
Tj	Trachelospermum jasminoides	Star Jasmine	0.3m	0.6m	47	150mm	Nil
Herbs	Sage, Nasturtiums, Perennial basil, Chives, Oregano		varies	0.3m	18	140 and punnets	Nil
TURF							
Stenotaphrum secundatum 'Sir Walter'			N/A	N/A		Rolls	N/A

EXISTING TREE SCHEDULE			
NO	TREE SPECIES	WORK	TREATMENT/COMMENT
1	Melia azedarach	REMOVE	Native species in fair condition. Exempt tree species
2	Thulia orientalis	REMOVE	Exotic copler in poor condition. Conflicts with proposed development

See Arborist Report prepared by Redgum Horticultural for detailed assessment of trees.



0 0.5 1 2M  
SCALE 1:100  
SCALE FOR PRINTING PURPOSE ONLY  
PRINTED @ A1 SIZE

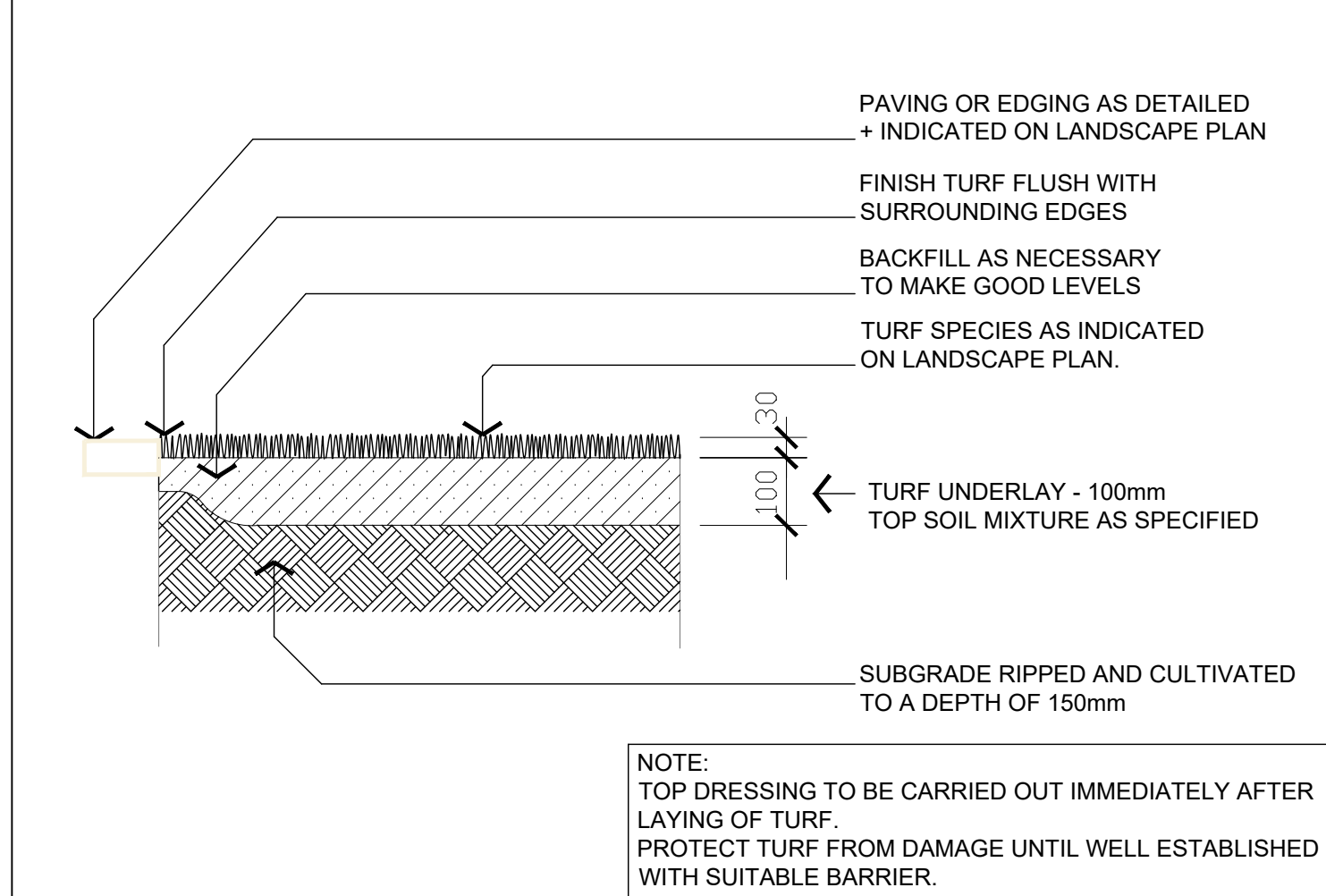

1 Ground Preparation for Turf  
Scale 1:10

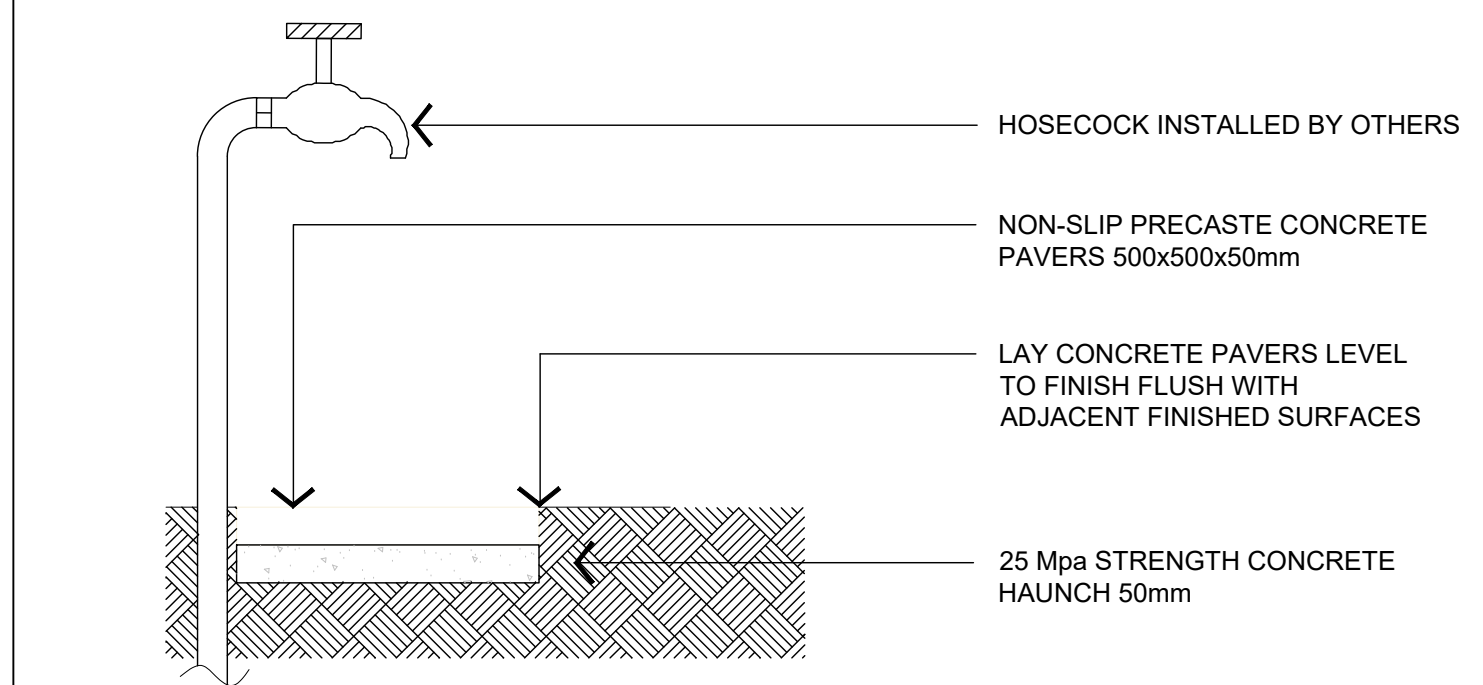

2 Brick Edge Laid on Flat  
Scale 1:10

4 Concrete Pavers Beneath Taps  
Scale 1:10

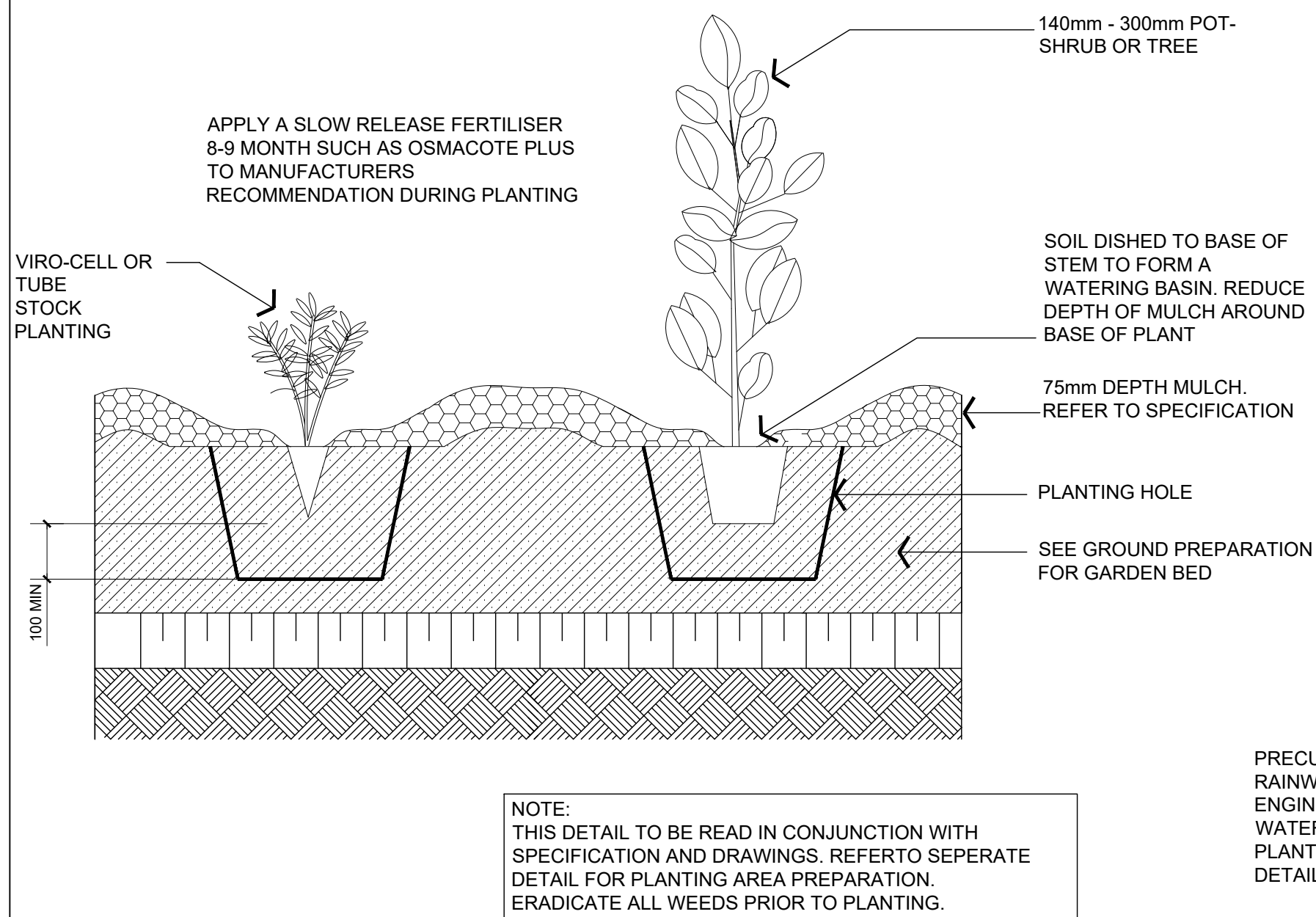

5 Shrub and Groundcover Planting - Viro-cell/Tube to 300mm  
Scale 1:10

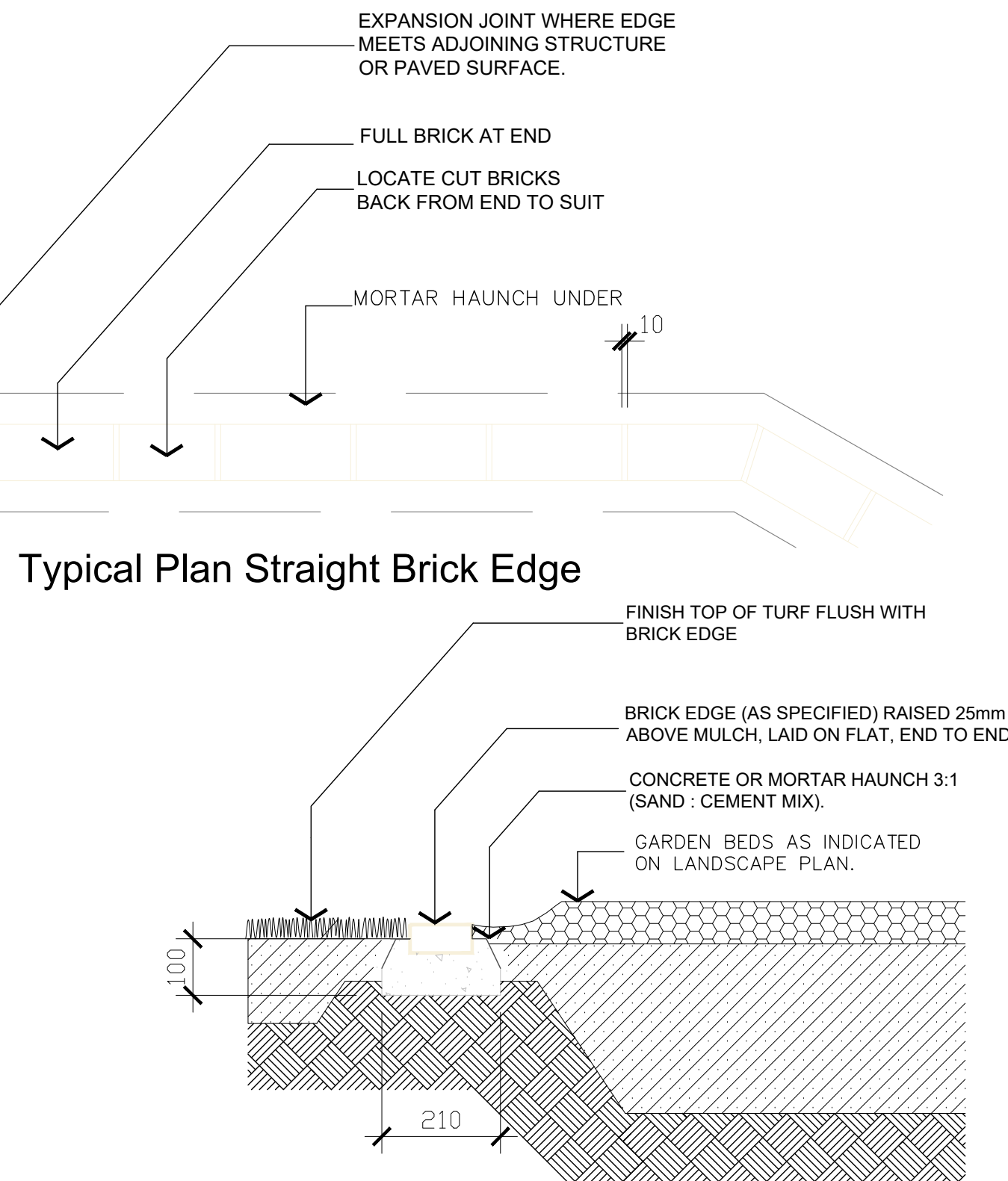

3 Ground Preparation for Garden Bed  
Scale 1:10

GENERAL NOTES:  
1. This drawing to be read in conjunction with Reference Specification for Housing Construction Prepared by Land and Housing Corporation and the landscape plan.  
2. Do not scale off drawing. Refer to dimensions shown on plan.  
3. All services to be checked and verified on site.  
4. For Hydraulic, Electrical, Civil and Structural Details refer to Engineers Drawings  
5. Prior to landscape works remove all builders debris, excavate all garden bed and turf areas to required levels and rip subbase to a minimum depth of 100mm as detailed.  
6. Ensure all excavated garden beds and tree planting have adequate drainage to prevent waterlogging during periods of high rainfall.

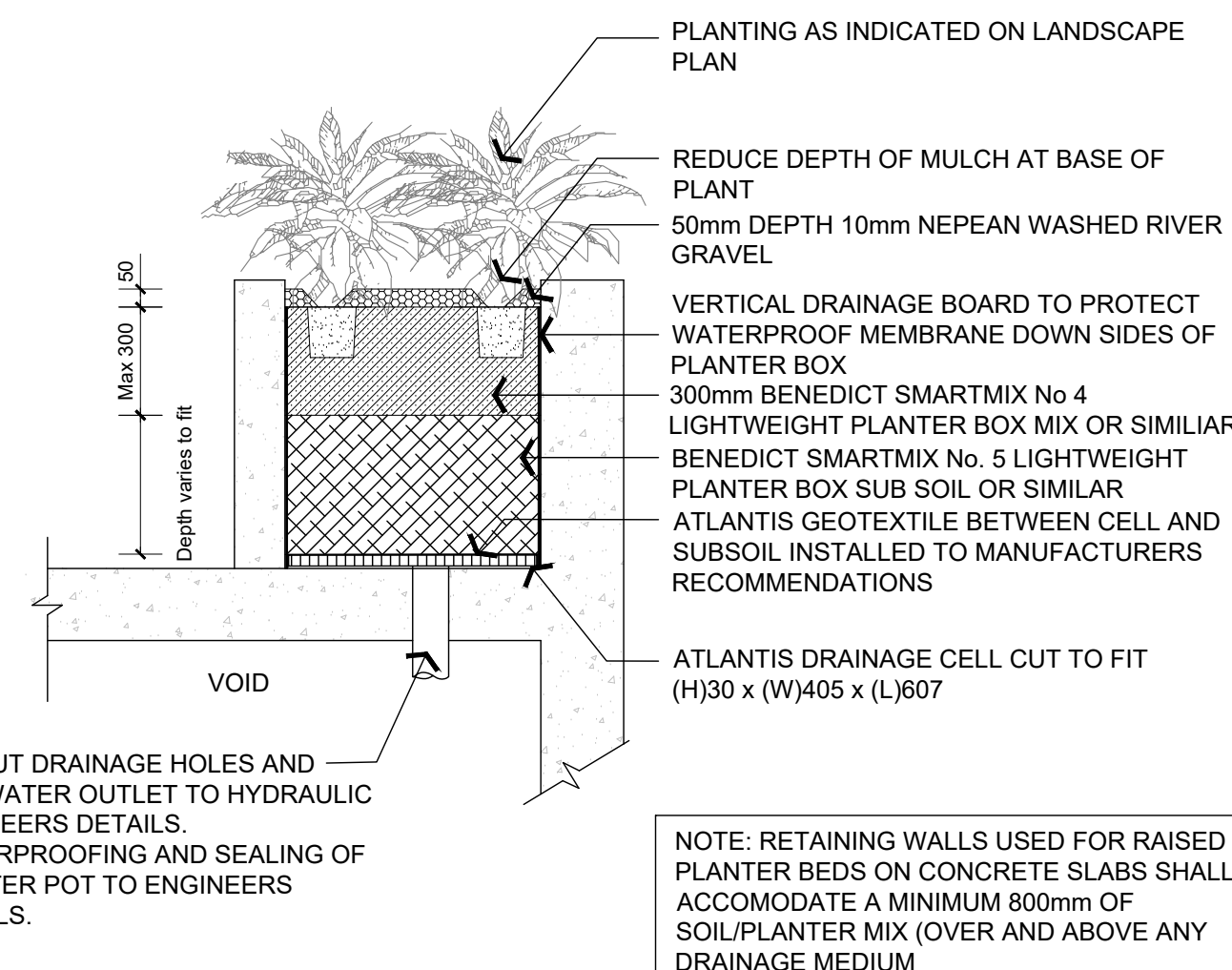

6 Planter Box on slab  
Scale 1:20

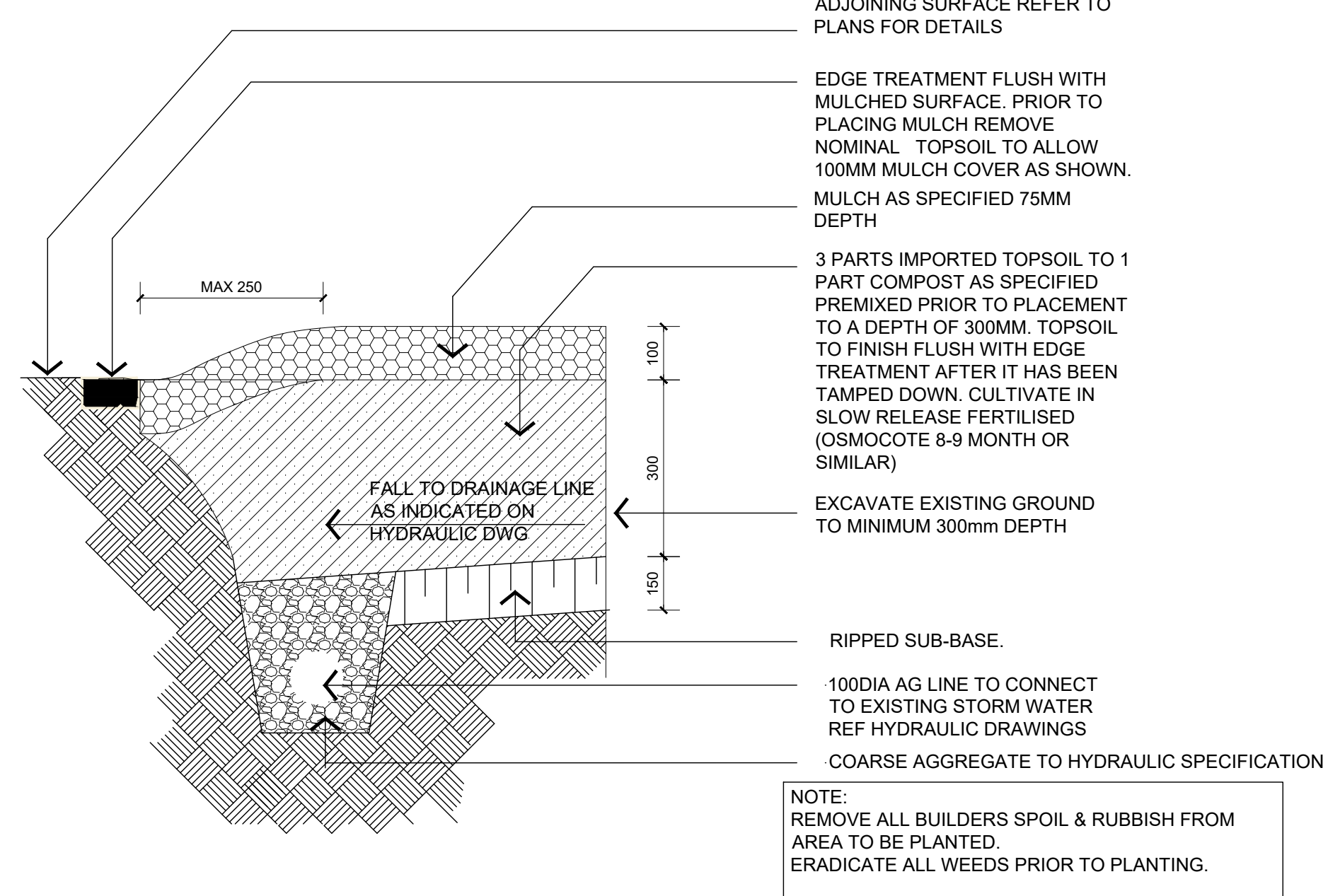

7 Trees In Garden Bed  
Scale 1:20

NOTE: THIS DETAIL TO BE READ IN CONJUNCTION WITH SPECIFICATION AND DRAWINGS. ERADICATE ALL WEEDS PRIOR TO PLANTING.

SUBSOIL DRAINAGE TO HYDRAULIC ENGINEERS DETAILS. WATERPROOFING AND SEALING OF SLAB & BUILDING UPURNS TO ENGINEERS DETAILS.

8 Planting over slab  
Scale 1:20

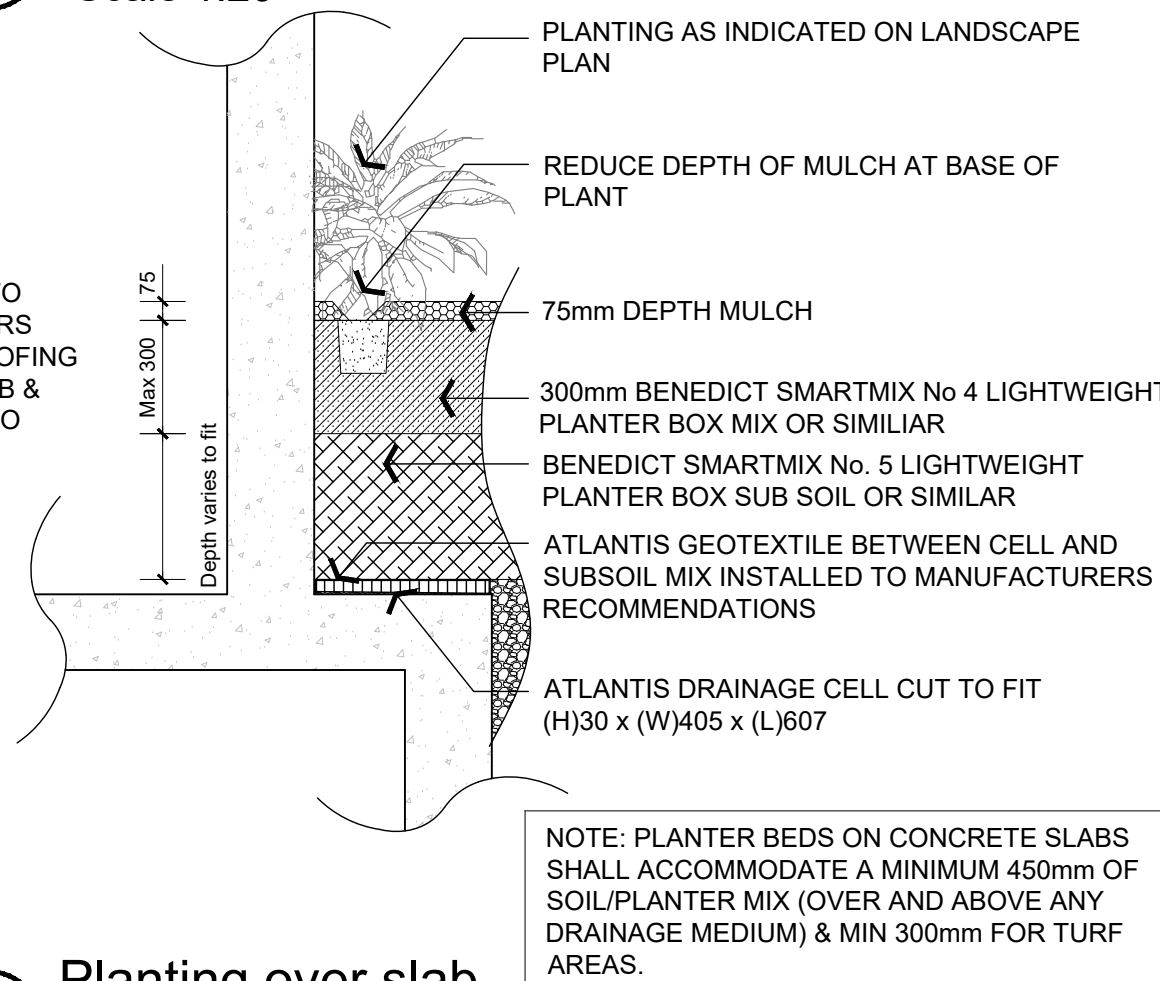

**IMPORTED TOPSOIL DESCRIPTIONS**  
Imported Topsoil: Sandy Loam (80% Medium/coarse river sand: 20% loam  
Planter Box Mix: Benedicts Smartmix No 4 or similar Benedicts Smartmix No 5 or similar  
Compost: spent mushroom compost, free from grass or weed of any kind. Uniform and evenly graded, inert a.d with a pH in the range from 5 to 7. To AS 4454  
Turf Underlay: topsoil for grassed areas with 20-40% loam component.  
Organic Topdressing: equal to AS 4544

#### SOIL SCHEDULE

Location	Soil Type and Mix	Depth Required
Turf	Turf Underlay	100mm
New Planting Beds	3 Parts Imported Topsoil to 1 Part Compost	300mm
Top dressing turf areas	Organic Topdressing Equal to AS 4544	10mm
Planter Box and on slab over OSD.	Benedicts Smartmix No 4	300mm
	Benedicts Smartmix No 5	subsoil - depth varies to fit.

#### SCHEDULE OF MATERIALS

**Brick Edge:**  
Brick or paver to be dry pressed. Colour and finish of brick to match architectural face brick, Austral bricks Wilderness Blackbutt

#### LANDSCAPE MAINTENANCE

Maintenance shall mean the care and maintenance of the landscape works by accepted horticultural practice as rectifying any defects that become apparent in the landscape works under normal use. This shall include, but shall not be limited to, watering, mowing, fertilising, reseeding, returfing, weeding, pest and disease control, staking and tying, replanting, cultivation, pruning, aerating, removing, topdressing, maintaining the site in a neat and tidy condition as follows:-

##### 1.0 GENERAL

The landscape contractor shall maintain the landscape works for the term of the plant establishment period of 13 weeks. During this time the landscape contractor shall attend to the site on a weekly basis or more frequently during period of extreme weather. The maintenance period shall commence at practical completion (after the 13 week establishment period) and shall continue for a period of twenty six (26) weeks.

##### 2.0 WATERING

Grass, trees and garden areas shall be watered regularly so as to ensure continuous healthy growth. Watering to be carried out in accordance with local water restrictions.

##### 3.0 RUBBISH REMOVAL

During the term of the maintenance period the landscape contractor shall remove rubbish that may occur and reoccur throughout the maintenance period. This work shall be carried out regularly so that at weekly intervals the area may be observed in a completely clean and tidy condition.

##### 4.0 REPLACEMENTS

The landscape contractor shall replace all plants that are missing, unhealthy or dead at the Landscape Contractor's cost. Replacements shall be of the same size, quality and species as the plant that has failed unless otherwise directed by the site supervisor. Replacements shall be made on a continuing basis not exceeding two (2) weeks after the plant has died or is seen to be missing.

##### 5.0 STAKES AND TIES

The landscape contractor shall replace or adjust plant stakes, and tree guards as necessary. Remove stakes and ties at the end of the maintenance period.

##### 6.0 PRUNING

Trees and shrubs shall be pruned so as to maintain dense foliage. Miscellaneous pruning to be carried out where beneficial to the condition of the plants. Any damaged growth shall be pruned. All pruned material shall be removed from the site.

##### 7.0 MULCHED SURFACES

All mulched surfaces shall be maintained in a clean and tidy condition and be reinstated if necessary to ensure that a depth of 75mm is maintained. Ensure mulch is kept clear of plant stems at all times.

##### 8.0 PEST AND DISEASE CONTROL

The landscape contractor shall spray against insect and fungus infestation with all spraying to be carried out in accordance with the manufacturer's directions Report all instances of pests and diseases (immediately that they are detected) to the client.

##### 9.0 GRASS AND TURF AREAS

The landscape contractor shall maintain all grass and turf areas by watering, weeding, reseeding, rolling, mowing, trimming or other operations as necessary. Seed and turf species shall be the same as the original specified mixture.

Grass and turf areas shall be sprayed with approved selective herbicide against broad leafed weeds as required in accordance with the manufacturer's directions.

Grass and turf areas shall be fertilised once during maintenance period with "Dynamic Lifter" for lawns at a rate of 20kg per 100m<sup>2</sup>. Fertiliser shall be watered in immediately after application. Irregularities in the grass and turf shall be watered in immediately after application.

Grass and turf areas shall be kept mown to maintain a healthy and vigorous sward. Mowing height: 30-50mm.

##### 10.0 WEED ERADICATION

Eradicate weeds by environmentally acceptable methods using a non-residual glyphosate herbicide (eg. "Roundup") in any of its registered formulae, at the recommended maximum rate. Regularly remove by hand, weed growth that may occur or recur throughout grassed, planted and mulched areas. Continue eradication throughout the course of the works and during maintenance period.